

SAFE OPERATING PROCEDURES

EZI-SPOT

100 & 200 LITRE EZI-SPOT



SAFE OPERATING PROCEDURES

100 & 200 Litre EZI-SPOT Sprayers

AN IMPORTANT MESSAGE FOR OWNERS & OPERATORS OF BA EZI-SPOT SPRAYERS

Safety is our primary concern in the design, manufacture, sale and use of BA Sprayers. BA Pumps & Sprayers would like to remind you of the safety rules when operating one of our sprayers or it's accessories.

Failure to follow these rules can result in severe injury or death. It is essential that everyone involved in the assembly, operation, transport, maintenance and storage of this equipment be properly trained in safety.

- Read this entire instruction manual together with the installation procedures before attempting to install or operate the sprayer.
- Prior to sprayer usage, all users and operators must have read and fully understood the contents of this operator's manual.
- Never allow inadequately trained personnel to attach or operate the sprayer.
- Be warned of the dangers of loading your UTV or another vehicle in excess of its carrying capacity.
- It is important to understand that any loads or attachments whether fastened to or placed on a vehicle or UTV will alter the stability or handling characteristics of that vehicle or UTV.
- Spray tanks or other equipment must be filled only to a level where the gross weight is within the load limit of the UTV or another vehicle.
- Never exceed the load limit capacity of the UTV or another vehicle.
- All UTV and trailed equipment tyres should be inflated to manufacturers recommended operating pressures.
- Please note that filling the spray tank and fitting sprayer accessories (eg: Spray booms) to the UTV may exceed the UTV's maximum load capacity. Do not exceed the manufacturer's guidelines.

Please note that 1 litre of water is 1 kilogram

- EZI-SPOT sprayers should be properly distributed and securely attached.
- Reduce speed when carrying cargo or pulling a trailer or trailed application equipment and allow greater distance for braking.
- Never allow anyone to ride on your sprayer or other equipment.
- Always follow the instructions in the owner's vehicle manual for carrying cargo or pulling a trailer.
- Proper maintenance of your UTV or another vehicle in line with manufacturer's recommended maintenance procedures is essential. (eg: Brakes and Suspension)
- All users of the UTV or other vehicle must be trained and competent in not only operating the vehicle, but also operating the vehicle when the attachment is being used.
- Before applying chemicals, read the SDS (safety data sheet) and label of the chemical manufacturer or supplier for personal protective equipment and operate as recommended.

- The safety of all chemicals used in agriculture is under the jurisdiction of a government agency, ie NZ Ministry for the Environment. Further local government laws may apply.
- BA recommend the use of a safety roll bar on your UTV
- BA recommend that EZI-SPOT are used on an RTV or a suitable UTV providing UTV manufacturers guidelines are fully observed
- This sprayer is designed and manufactured solely for the purpose of applying agricultural chemicals to crops. Under no circumstances may it be used for any other purpose.
- Before carrying out any maintenance work wash the sprayer thoroughly. Remove all toxic chemicals that may contaminate the machine.
- Do not point the spray gun at a human's body as high-pressure spray may cause serious bodily harm.
- After completing spraying task in the field, turn the pump off at the switch and discharge the residual pressure in the hose by activating the gun/lance trigger handle. This will prevent accidental discharge by a 3rd party at any later stage.

NOTE – **DO NOT** loan your sprayer to anyone without providing full operator safety and operating training

Throughout this manual, there are safety warnings and operational tips. Please thoroughly read this whole manual for your safety.

To reduce the chance of UTV instability it is essential that the UTV is stationary when spot spraying as divided attention leads to rollover incidents, especially when spraying on slopes or next to streams or ditches.

Please note that you will not be able to ride the same speed/slopes/hills on your UTV once your sprayer is filled.

BA Pumps & Sprayers Warranty Policy

All products

Private Domestic Use	12 months
Private and Commercial Agriculture	12 months
Agricultural Contractors	6 months
All Non-Agricultural Applications	3 months

The warranty period begins on the date the product is delivered to the first retail purchaser.

BA Pumps & Sprayers warrants the owner that it will repair or replace without charge parts found defective or malfunctioning in accordance with the warranty limitation and adjustment schedule below.

- BA Pumps & Sprayers (Company) hereby warrants to the original purchaser (Owner) of this machine against faulty material and workmanship for a period as described above after delivery according to the conditions outlined.
- This Warranty does not extend to any part or parts of the machine not manufactured by the said Company. These parts being covered by the Warranty of the makers.
- This Warranty does not extend to defects due to parts damaged by the neglect, misuse or negligence of the purchaser or any damage caused as a result of incorrect installation of the machine or to normal wear.
- This Warranty does not extend to any damage to tanks due to the chemicals being used or left in tanks when not in use.
- In the event of a defect occurring within the said period as stated above, the purchaser must not attempt to correct or remedy such defect either by modification of, adjustment or alteration to any part or parts of the machine.
- This Warranty will stop by right if the product is used in a manner not up to the manufacturer's directions or for bad maintenance.
- In the event of any defect being disclosed to BA Pumps & Sprayers within the specified period, BA Pumps & Sprayers, after due examination and on being satisfied that such defect is due to faulty material or workmanship undertakes to repair or replace such defective part or parts free of charge.
- Freight and labour costs in relation to any replacement under this warranty are the responsibility of the purchaser.
- In no event shall BA Pumps & Sprayers be liable for downtime expenses, loss of chemicals, loss of machine use or other incidental, consequential or special damages.
- This warranty is subject to the following conditions, which must be conformed to by the purchaser.

CONDITIONS OF WARRANTY

1. The warranty is NOT transferable.
2. The purchaser must complete the Warranty Registration Form on our website upon completion of starting the machine. The form must be completed within 14 days of delivery of the unit. Only when this is completed and returned, can BA Pumps & Sprayers fulfil all obligations. The form can be found at: www.bertolini.co.nz/warranty-registration
3. Abuse: Failure resulting from neglect, such as improper operation, lack of required maintenance or continued use of a sprayer after the discovery of a defect which results in greater damage to the unit.

BA Pumps & Sprayers Warranty Policy

- **Environmental Conditions and Application:** Deteriorated or failed components such as diaphragms, O'rings, hoses, seals, electrical wiring and connections damaged by corrosive chemicals dirt and sand, excessive heat or moisture. Owners should ensure the type and strength of chemicals used in the sprayer are compatible with the design of the unit. Warranty determination for these types of failures will be made BA Pumps & Sprayers only after inspection of failed components. In most instances, these will incur inspection charges and cost of replacement parts.
- **Normal Wear:** Normal wear and consumable items such as oils and lubricants, diaphragms, filter elements, flow meters, clutches, pivot pins, paint, and nozzles are considered to be normal wear items and are not warranted.
- **Maintenance:** Component failure caused by not performing scheduled maintenance service such as oils, grease, failure to clean tanks, pumps, filters, spray lines, nozzles, fans or any other blocked components. Not tightening or replacing loose or missing bolts, nuts, fittings, shields and covers.
- **Damage:** Damages or machine failure, caused by carelessness or accidental damage, improper operation, inappropriate transportation or storage of the sprayer or attachment.
- **Power Source:** Failures due to faulty or inadequate electrical sources of power. Owners who use their own 12-volt power source must make sure that it is suitable for operating the spraying equipment.
- **Alterations:** Any unauthorised alteration, modification, attachments or unauthorised repairs to the sprayer or attachments. Written approval must be obtained from BA Pumps & Sprayers for any such items to maintain the warranty.
- **Removal and Installation:** The time taken to remove and re-install a warranted part or component into other brands of sprayers will not be covered by the BA Pumps & Sprayers Warranty. Only parts and labour directly attributable to the repair of the sprayer is covered.
- **Clean-up Time:** BA Pumps & Sprayers does not pay for cleaning the sprayer, parts, accessories or work area before or after the warranty repair. Clean-up time is affected primarily by the application or conditions in which the sprayer is operated and maintained. Since clean-up time can be so variable, cleaning time should be considered a customer expense.
- **Transportation Costs:** Warranty does not cover transportation or insurance costs for sprayers or other equipment needing repair or replacement of warranted components. Nor does it cover any freight or insurance costs in obtaining new parts or returning old parts to BA Pumps & Sprayers for inspection purposes.
- **Travel Time:** Travel time required for warranty repairs is the responsibility of the Owner.
- **Diagnostic Time:** Warranty does not cover the time required to diagnose a warranty problem. Diagnostic time is affected greatly by the training and expertise of the technician employed to do the job. With proper training of service personnel, diagnostic time should be at a minimum. BA Pumps & Sprayers expects that their Agents are well trained and proficient to handle any warranty repairs. Since BA Pumps & Sprayers is not in control of these responsibilities, we elect not to cover diagnostic time.
- **Non-Genuine Repairs:** Use of parts other than genuine parts for repair of warranted parts will automatically negate any guarantee. Warranted components must be replaced with genuine BA Pumps & Sprayers repair parts.
- **Unauthorised Repairs:** Repairs by an unauthorised agent will automatically forfeit any warranty. Warranty repairs must be carried out by an authorised BA Pumps & Sprayers dealer only.
- **Disclaimer:** The contents of this manual are published and given in good faith. However, neither BA Pumps & Sprayers nor any of its associates or directors or employees give any warranty of accuracy nor accept any responsibility in law. No reader should act on the basis of any matter contained in this manual without considering and taking appropriate advice based upon their particular circumstance. BA Pumps & Sprayers.
- **Due to continuous product development, BA Pumps & Sprayers reserves the right to change specifications and design without notice**

To the Owner of this Sprayer

Our sprayers have been designed and manufactured with the discerning operator in mind. BA Pumps & Sprayers provides long-term durability by using the finest materials in the construction of our products. This booklet deals with the Warranty, Operation and Trouble Shooting of the EZI-SPOT range of sprayers. Read thoroughly before attempting to use your sprayer. If you are unsure of any aspect, ask the dealer who supplied the machine to explain any unclear points.

EZI-SPOT SPRAYERS

Whether you are a commercial grower or home gardener, you will find many uses for this unit. The tank, pump and wand fittings are corrosion resistant and are suitable for applying weedicides, herbicides, insecticides, fungicides, miticides, and green formulations. The unit is designed for spot-spraying but may be used in conjunctions with a boom for boom spraying.

Please read the safety instructions before installing or operating your sprayer

Specifications

	<i>EZI-SPOT 100</i>	<i>EZI-SPOT 200</i>
Length	850mm	1110mm
Width	540mm	640mm
Height	400mm	640mm
Dry Weight	13kg	21kg
Capacity	100 litres	200 litres

Pump

SHUR-flo 8000 series, 12-volt DC electric, 6.8 litres per minute open flow, 107PSI on demand pump with electric pressure switch and internal bypass for smooth operation

Hose

EZI-SPOT 30 and 50, 6-metre delivery hose standard.
QUAD-PRO 50, 10 metre delivery hose standard.

Lance

Lightweight spray lance with adjustable nozzle pattern.

Tank

The 30 and 50-litre blue translucent tanks are made from UV stabilized and impact resistant polyethylene. The screw on lid incorporates an anti-spill breather.

Filtration

TeeJet 122 series line strainer. QUAD-PRO 50 is fitted with a lid strainer basket.

Controls

On/Off power switch. The pump is fitted with an automatic electric pressure sensing switch which automatically starts the pump when the pressure falls below 40 psi and stops the pump when the trigger is opened and stops when the trigger is closed. The internal bypass (Smoothflow) pump ensures a constant application.

Installation

Unpack the sprayer and check all parts are included and nothing is damaged. Items included for each model are listed in the below chart.

Item	<i>EZI-SPOT 100</i>	<i>EZI-SPOT 200</i>
Tank with pump	✓	✓
Battery cable assembly	✓	✓
Spray Hose	✓	✓
Spray lance	✓	✓
Operators manual	✓	✓

PLEASE CHECK VEHICLE MANUFACTURERS SPECIFICATIONS FOR COMPATIBILITY BEFORE FITTING YOUR SPRAYER

Connection to 12-volt DC supply

The sprayer requires a 12-volt DC power source. A 2-metre loom is provided to allow the sprayer to be connected to the 12-volt DC battery. The red wire is positive and the black is negative. An on/off switch is fitted to the sprayer to allow the sprayer to be disconnected from the 12-volt source to prevent the accidental drain of power. The switch also allows the pump to be shut down when the tank is empty preventing overheating and damage to the pump. It is recommended that if installing the sprayer on an UTV or any vehicle that a 10 amp fuse be installed to prevent any potential damage to the electrical system on the vehicle. Consult your vehicle instruction manual for the correct electrical connection.

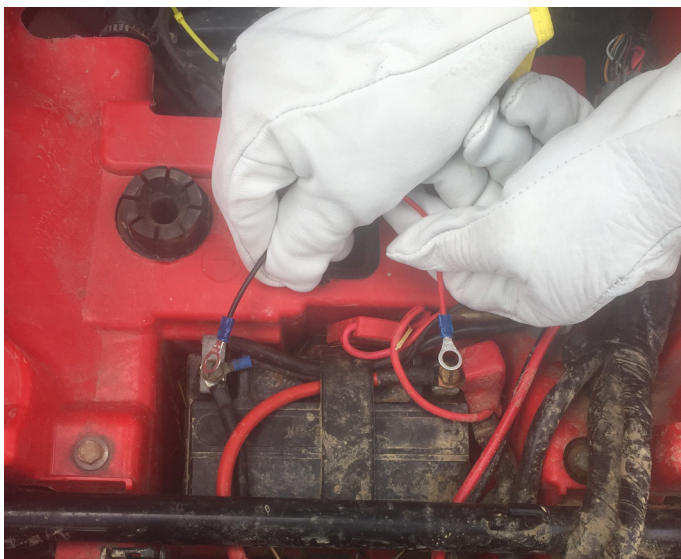

- **To avoid damage to the pump to ensure the red wire is connected to the positive battery terminal.**
- **To avoid fire do not remove the fuse and ensure the wiring loom is not located near hot engine parts or the exhaust.**

Mounting the Spray Tank

Position the sprayer so as to minimize contamination of the operator, preferably on the rear carrier if fitting to an UTV. With the pump away from the operator the risk of contamination due to hose failure can be minimized.

The sprayer should be mounted centrally as near to the centre of the gravity of the UTV as possible. It should not protrude so as to not cause an obstruction. Refer to manufacturer's instructions for appropriate load limits and fitting instruction. Never fill the tank to beyond the vehicle's weight limits.

Please note that 1 litre of water is 1 kilogram

Ratchet Strap

It is recommended that the sprayer is securely attached to any RTV or another vehicle with tie down straps. To prevent any movement when fitted, these should be firmly secured to approved attachment points on the RTV or another vehicle.

BAM100 Strap Position



BAM200 Fitting Spray Gun Holder

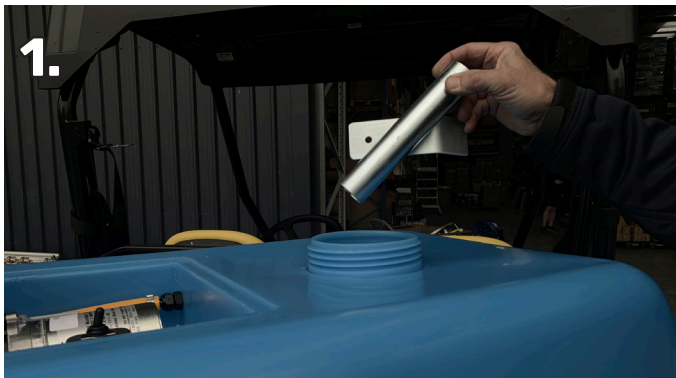

BAM200 Strap Position

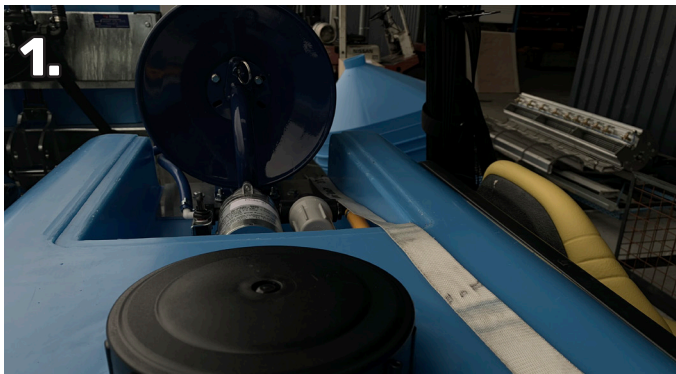

Operating Instructions

- Fill the sprayer with clean water.
- Check suction line strainer for dirt or damage.
- Connect pump and ensure it primes correctly, holding the spray lance trigger on until it sprays steadily.
- Check all pipes, hoses, hose clamps and connections for leaks or damage.

Hints

Spray Hose - Be careful not to wrap the hose so tight as to inhibit the flow of fluid by kinking the hose.

Length of Spray Hose - If most spraying is "from the seat", the hose length should be shortened. Please contact your nearest dealer for options.

Nozzle Choice - Nozzles provided have been selected to match the performance of the pump. The adjustable nozzle gives a cone pattern, ideal for spot spraying

CHEMICAL APPLICATION

CAUTION

This handgun sprayer is not a high-volume sprayer nor is it ultra-low volume. As a general rule for most spotting applications, label rates under the heading "knapsack rates" would apply. As no control can be exercised over the use of the equipment or over weather, plant or soil conditions, or over the storage, handling, mixing, use or application of sprays or chemicals, BA Pumps & Sprayers will not accept any liability for loss or damage (consequential or otherwise) arising directly or indirectly from the use of this equipment.



BAM100



BAM100-HR-15



BAM200-HR

Chemical Advice

BA Pumps & Sprayers or their agents cannot make recommendations or give advice as to the use of chemicals and cannot accept responsibility for any damage, injury or other consequence for disregarding this warning notice. Refer to the SDS (safety data sheet) that came with your chemical. This sheet holds all the information users need for their protection and should be read carefully before application. Contact your chemical supplier for further advice.

WARNING

Mixing chemicals is a most dangerous activity as it involves handling the concentrated material. For toxic compounds, use protective clothing such as overalls, hat, gloves, safety glasses, boots and a respirator. Note: People with beards do not get full protection from normal masks and respirators.

When using diluted sprays always wear at least a hat, long-sleeved cotton overalls, safety glasses, respirator and boots. If you use pesticides regularly, it is a good idea to always wear a respirator to avoid accumulation of toxins in the body. Other protection may be required. Check the SDS and labels for specific directions for the particular chemical. Purchasers must ensure that operators of these machines are fully trained, competent and aware of the dangers of spraying chemicals and the application of each spray used.

Care of Protective Clothing

Protective clothing should be properly cared for. Rinse heavily contaminated clothes in the open before washing in the laundry. Wash and dry these clothes every day and keep them separate from other washing.

Respirators need special care. Clean the respirator after spraying. Use soapy water then rinse and allow to dry completely before storing in a clean plastic bag. Replace canisters in respirator after eight hours use. Never store used canisters with the respirator.

The minimum requirements for personal safety are that the operator avoids spray inhalation and does not allow chemicals or spray mixture to contaminate the eyes or skin.

General Guidance

Do Spray:

- Only after reading this instruction manual carefully and following the advice given.
- With pump pressures as low as possible consistent with chemical container label conditions and nozzle type.
- With nozzles that reduce spray drift to a minimum.
- With booms as close to the ground as practicable.
- With less than a 5km wind.
- Using the correct personal protective equipment specified on the label of the chemical container.

Don't Spray:

- With booms higher than is necessary, and no more than about one metre above the ground.
- In a figure eight or a similar pattern.
- Unless you have been trained to spray using an UTV or RTV.
- Holding the spray lance while driving the UTV.
- In winds higher than 5km.

Care and Maintenance

Always fill the sprayer from a clean water source. The line strainer should be checked and cleaned if necessary each time the tank is filled. Appropriate protective equipment should be used whenever maintenance is carried out.

Cleaning

Clean the sprayer regularly! After each use, flush the unit out three times with fresh water. Use a neutralizing agent for the second rinse.

CAUTION

To prevent damage to the sprayer and spray gun, drain the water from the sprayer and spray gun when there

Shutdown and Storage

Check the chemical manufacturer's label for disposal of the chemical. Drain the excess material from the tank. Select an appropriate place (one that will not endanger animals or the environment) for cleaning and flushing the system. Flush tank, pump and hose until they flow clean. This prevents the build-up of residues in hoses and pump valves. If there are heavy frosts, run the pump to make sure the pump and spray lines are dry. This will prevent water from freezing in the pump or spray lines and damaging the sprayer.

Trouble Shooting For 12 Volt Shurflo Diaphragm Pumps

PROBLEM	PROBABLE CAUSE	REMEDY
Pump starts but doesn't prime	Low Voltage	Check electrical connection
	No liquid / low liquid	Food filter (if fitted) not fully submerged. Check liquid level Check suction hose for kinks
	Air leak in the inlet line Damaged / sticky valves Debris in pump	Check fittings and in-line filter o' ring Replace / clean valves Clean filter Check for debris in the bottom of tank
External leak from the pump head	Blocked Filter	Clean / replace
	Worn or dislodged valve	Replace o rings
	Suction/delivery line	Fit lines to correct ports or fitted vice-versa
Suction Leak	Ruptured diaphragm	Replace diaphragm
	Piston screw loose	Tighten piston screws
	Piston screw cross threaded	Re-thread and fit the new screw
Pump running rough or noisy	Pinched diaphragm	Replace diaphragm
	Cracked upper housing	Replace upper housing
	Inlet fitting lose	Tighten fitting
Low Performance	Cracked valve housing	Replace valve housing
	Faulty motor	Replace motor
	Loose body screws	Tighten screws
The pump will not start	Broken magnet in motor housing	Replace motor
	Damaged bearing	Replace bearing
	Blocked filter	Clean / replace
Low Performance	Improper voltage	Check wiring and connections
	Worn / damaged valves	Replace valves
	Loose fasteners	Tighten fasteners
The pump will not start	Motor faulty	Replace motor
	Loose/contaminated connection	Check all connections
	Failed pressure switch	Replace broken pressure switch
	Damaged/worn brushes/ broken brushspring	Replace brush housing assembly
	Blown main fuse	Replace fuse
	No power to pump	Check power source and all connections

Service Bulletin

Shurflo Pumps

A number of 12-volt diaphragm pumps are being returned to BA Pumps & Sprayers for repair and / or suspected warranty replacement. In many instances, the problems identified were minor and could be easily rectified. To facilitate the spot assessments and rectifications, the above Trouble Shooting information has been provided for your use. These checks need to be performed prior to submission of suspected warranty claims or requests for replacement pumps. If further assistance is required please contact our customer service staff on 07 847 7950.

Other Useful Information

Pressure Operation Switch (If Equipped)

The pressure switch reacts to outlet pressure and interrupts power at the preset shut-off pressure indicated on the pump label. When outlet pressure drops below the preset limit, the switch will close and the pump operates until the shut-off (high) pressure is achieved. The shut-off pressure is set to factory calibrated standards and shouldn't be re-adjusted.

Mounting

The pump may be mounted in any position. However, if mounting the pump vertically the pump head should be in the down position so that in the unlikely event of a leak, fluid will not enter the motor.

Optional Upgrades



3M Galvanised Folding Spray Boom

#BA300N-K



BA 2XP BOOM JET KIT

#BA2XP-10-C/WMN

Comes with No.10 Nozzles
Suits 11 lpm Pump



TEEJET FERTJET NOZZLE

#FJK-5 or 9

Single nozzle for liquid fert, 5M coverage. Requires 6.8 lpm pump



BA PK Pistol with Swivel Fitting and Rated 800 PSI

#PK85200K

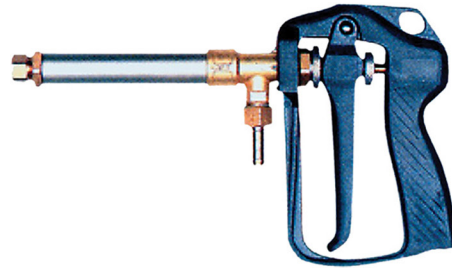

Braglia Spot Spray Gun with 10mm Hose Tail

#35.901.16

For More Info
Call Us On

0800 833 538

BAM100



2

1

16

17

CORRECT AS OF JULY 2019. ALL PARTS LISTS ARE ALSO AVAILABLE ON OUR WEBSITE

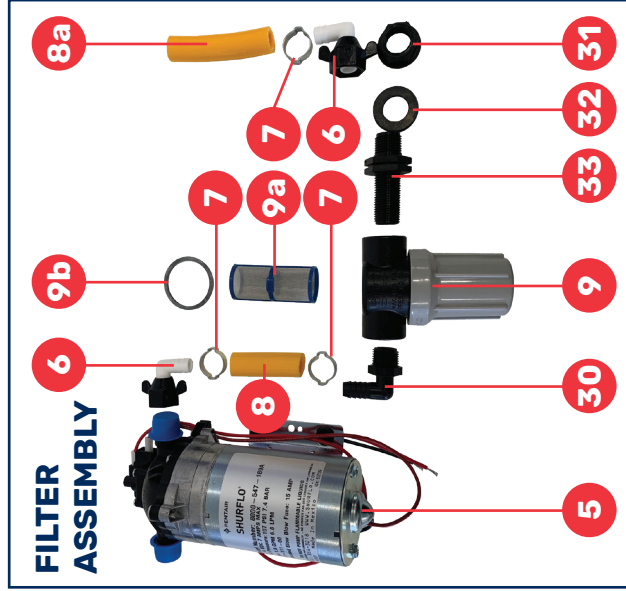

FILTER ASSEMBLY



PUMP



DRAIN ASSEMBLY



HOSE AND GUN ASSEMBLY



ELECTRICAL ASSEMBLY KIT

BAM100 12 VOLT SPRAYER PARTS LIST

No.	Part No.	Description	QTY
1	110TANK	Tank & Tank Fittings	1
2	3542010	110 litre deckmount tank	1
3	TN5088PP	Lid BAM tank female	1
	20102020	Nipple 1/2" x 1/2" PP Drain	1
	CP19438-EPR	Drain Cap	1
4	2787-1	Drain Cap Gasket	1
		Drain Plug	1
5	8000-547-189	Pump & Filter Assembly	1
6	8-034-01	Shurflo 6.8lpm, 107psi 12 volt pump	2
7	1366	Shurflo elbow hose tail 1/2"	2
8	1353	Otiker clip 1300 hose	0.2mtr
8a	1353	Ag spray hose 13mm 600psi	0.5mtr
9	AAB122-1/2-PP	Hose ag spray 13mm 600 psi (inside tank)	1
9a	CP45102-3-SSPP	Complete 1/2" line filter with 50 mesh	1
9b	CP23173-EPR	50 mesh screen replacement part	1
33	2502021	Filter bowl gasket	1
32	G40002	1/2" elbow tail and backnut 1/2" nipple	1
31	2052020	Gasket 1/2"	1
30	TE2088PP	1/2" backnut	1
		1/2" barb elbow	1
11	1559	Electrical Assembly	1
11a	1560	Fuse holder	1
12	BAMLOOM	Fuse (mini 10AMP)	1
13	1561	Wiring loom	1
14	1562	Cover (switch w/proof)	1
15	1866	Switch	1
18	BAMSWITCHASSY	Switch Bracket	1
		Full electrical assembly kit (includes all the above)	1

No.	Part No.	Description	QTY
16	BAMHOSEKIT1	Hose & Lance Assembly	1
16a	8-060-01	Hose with pump fitting	1
	1351	Hexnut swiv elbow 3/8" s/flo	6mtr
	1365	Ag spray hose 8.5mm 600psi	2
17	50800-15-PP-406	Otiker clip 10/8.5mm hose	1
	CP50786-PP-406	TriggerJet - PP	1
17a	387200-PP-X18	TriggerJet inlet hose tail	1
		TriggerJet nozzle assembly	1
		Sundry Components	
	1077	Pump mount screws 3/16X1 ZP	4
	1122	Pump mount washers M6	4
	1565	Bullet terminal male - BAMs	2
	1566	Bullet terminal female - BAMs	2
	1569	Eye terminal 8M	2
	1564	Spade terminal	2
		Optional Upgrades	
	2088-343-135	Shurflo 11.3lpm, 45psi 12 volt pump	1

CORRECT AS OF JULY 2019. ALL PARTS LISTS ARE ALSO AVAILABLE ON OUR WEBSITE

BAM100-HR-15



CORRECT AS OF JULY 2019. ALL PARTS LISTS ARE ALSO AVAILABLE ON OUR WEBSITE

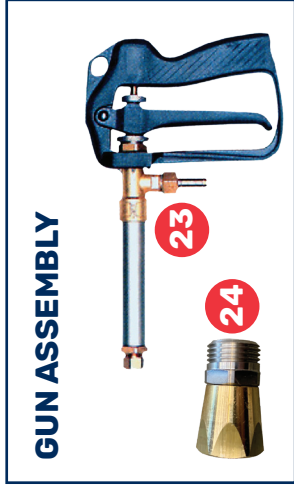
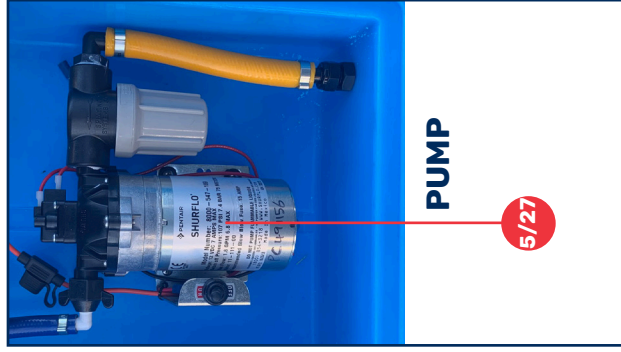
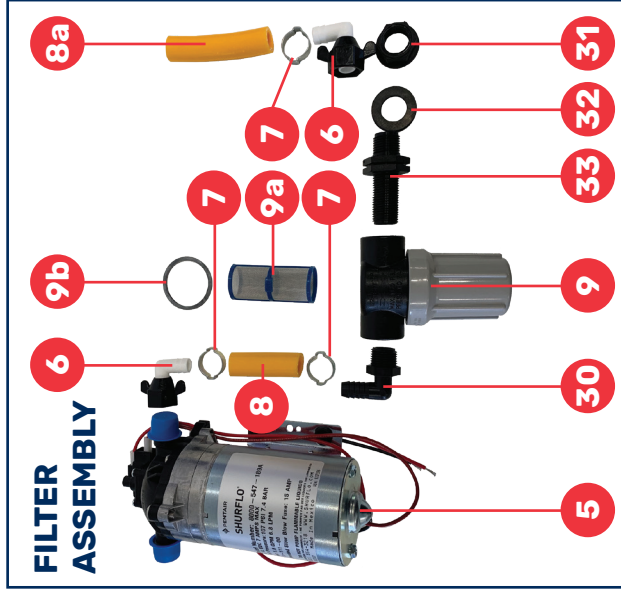
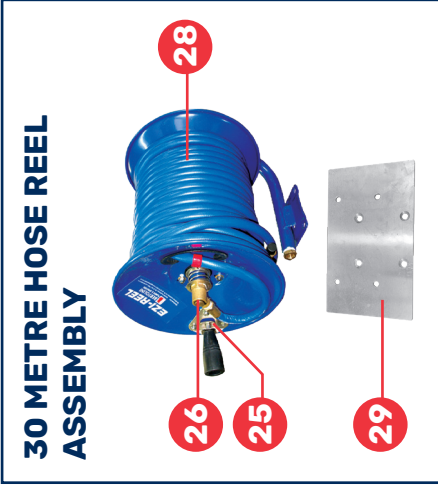



BAM100-HR-15 12 VOLT SPRAYER PARTS LIST

No.	Part No.	Description	QTY
1	110TANK	Tank & Tank Fittings	
2	3542010	110 litre deckmount tank	1
3	TN5088PP	Lid BAM tank female	1
	20102020	Nipple 1/2" x 1/2" PP Drain	1
	CP19438-EPR	Drain Cap	1
4	2787-1	Drain Cap Gasket	1
		Drain Plug	1
5	8000-547-189	Pump & Filter Assembly	
6	8-034-01	Shurflo 6.8lpm, 107psi 12 volt pump	1
7	1366	Shurflo elbow hose tail 1/2"	2
8	1353	Otiker clip 1300 hose	3
8a	1353	Ag spray hose 13mm 600psi	0.2mtr
9	AAB122-1/2-PP	Hose ag spray 13mm 600 psi (inside tank)	0.5mtr
9a	CP45102-3-SSPP	Complete 1/2" line filter with 50 mesh	1
9b	CP23173-EPR	50 mesh screen replacement part	1
33	2502021	Filter bowl gasket	1
32	G40002	1/2" elbow tail and backnut 1/2" nipple	1
31	2052020	Gasket 1/2"	1
30	TE2088PP	1/2" backnut	1
		1/2" barb elbow	1
11	1559	Electrical Assembly	
11a	1560	Fuse holder	1
12	BAMLOOM	Fuse (mini 10AMP)	1
13	1561	Wiring loom	1
14	1562	Cover (switch w/proof)	1
15	1866	Switch	1
18	BAMSWITCHASSY	Switch Bracket	1
		Full electrical assembly kit (includes all the above)	1

No.	Part No.	Description	QTY
		Sundry Components	
	1077	Pump mount screws 3/16X1 ZP	4
	1122	Pump mount washers M6	4
	1565	Bullet terminal male - BAMs	2
	1566	Bullet terminal female - BAMs	2
	1569	Eye terminal 8M	2
	1564	Spade terminal	2
19	P95520-14	Hose Reel & Gun	
20	SJ202	Hose reel mount lower	1
25	3063-1	15mtr EZI-Reel	1
26	3063	Hose reel handle	1
23	35.901.16	Hose reel swivel	1
24	26.1502.45	Spot 300 spray gun	1
		Swivel for spray gun	1
27	2088-343-135	Optional Upgrades	
28	SJ201	Shurflo 11.3lpm, 45psi 12 volt pump	1
29	P97003-01	30mtr EZI-Reel	1
		30mtr hose reel bracket	1

CORRECT AS OF JULY 2019. ALL PARTS LISTS ARE ALSO AVAILABLE ON OUR WEBSITE

BAM200

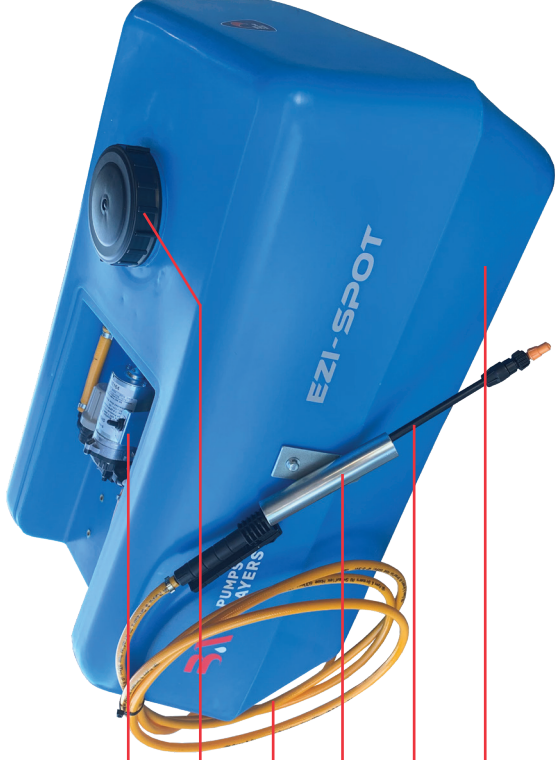

- 5
- 2
- 16
- 19
- 17
- 1

CORRECT AS OF JULY 2019. ALL PARTS LISTS ARE ALSO AVAILABLE ON OUR WEBSITE

FILTER ASSEMBLY

- 9
- 10
- 7
- 8
- 7
- 30
- 31
- 32
- 33
- 9a
- 9b
- 8a
- 7

PUMP

- 5/27
- 6

DRAIN ASSEMBLY

- 3
- 4

HOSE AND GUN ASSEMBLY

- 16
- 17
- 17a

ELECTRICAL ASSEMBLY KIT

- 11
- 11a
- 12
- 13
- 14
- 15
- 18



BAM200 12 VOLT SPRAYER PARTS LIST

No.	Part No.	Description	QTY
1	200TANK	Tank & Tank Fittings 200 litre deckmount tank	1
2	3542010	Lid BAM tank female	1
3	TN5088PP	Nipple 1/2" x 1/2" PP Drain	1
	20102020	Drain Cap	1
	CP19438-EPR	Drain Cap Gasket	1
4	2787-1	Drain Plug	1
		Pump & Filter Assembly	
5	8000-547-189	Shurflo 6.8lpm, 107psi 12 volt pump	1
6	8-034-01	Shurflo elbow hose tail 1/2"	1
7	1366	Otiker clip 1300 hose	3
8	1353	Ag spray hose 13mm 600psi	0.2mtr
8a	1353	Hose ag spray 13mm 600 psi (inside tank)	0.5mtr
9	AAB122-1/2-PP	Complete 1/2" line filter with 50 mesh	1
9a	CP45102-3-SSPP	50 mesh screen replacement part	1
9b	CP23173-EPR	Filter bowl gasket	1
10	TE2088PP	Male threaded elbow hose tail	1
33	8121-NYB-540TD	1/2" elbow tail and backnut	1
32	G40001	Gasket 3/8" 25x16x3 white nitr	1
31	8400-500-NYB	Hose shank connector	1
30	CP8027-NYB	TeeJet cap nylon	1
		Electrical Assembly	
11	1559	Fuse holder	1
11a	1560	Fuse (mini 10AMP)	1
12	BAML00M	Wiring loom	1
13	1561	Cover (switch w/proof)	1
14	1562	Switch	1
15	1866	Switch Bracket	1
18	BAMSWITCHASSY	Full electrical assembly kit (includes all the above)	1

No.	Part No.	Description	QTY
16	BAMHOSEKIT1	Hose & Lance Assembly Hose with pump fitting	1
	8-060-01	Hexnut swiv elbow 3/8" s/flo	1
	1351	Ag spray hose 8.5mm 600psi	6mtr
	1365	Otiker clip 10/8.5mm hose	2
17	50800-15-PP-406	TriggerJet - PP	1
	CP50786-PP-406	TriggerJet inlet hose tail	1
17a	387200-PP-X18	TriggerJet nozzle assembly	1
19	P95493	Spray gun holster	1
		Sundry Components	
	1077	Pump mount screws 3/16X1 ZP	4
	1122	Pump mount washers M6	4
	1565	Bullet terminal male - BAMs	2
	1566	Bullet terminal female - BAMs	2
	1569	Eye terminal 8M	2
	1564	Spade terminal	2
		Optional Upgrades	
	2088-343-135	Shurflo 11.3lpm, 45psi 12 volt pump	1

CORRECT AS OF JULY 2019. ALL PARTS LISTS ARE ALSO AVAILABLE ON OUR WEBSITE

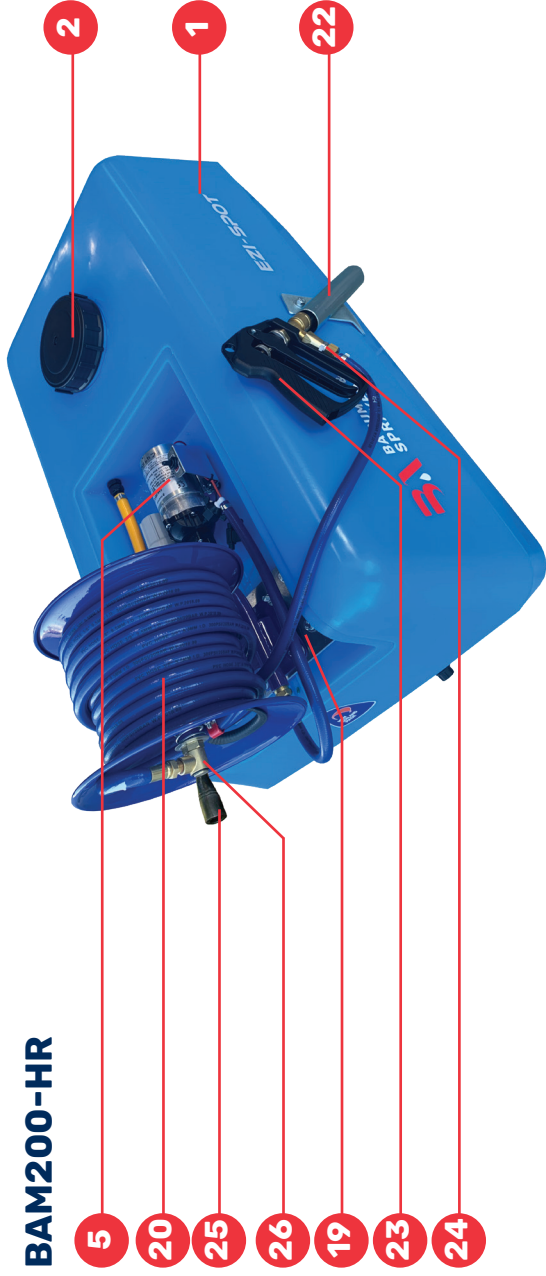

BAM200-HR

- 5
- 20
- 25
- 26
- 19
- 23
- 24

CORRECT AS OF JULY 2019. ALL PARTS LISTS ARE ALSO AVAILABLE ON OUR WEBSITE

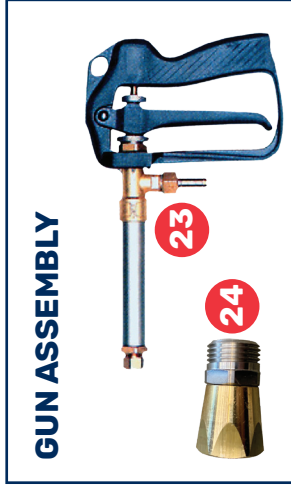
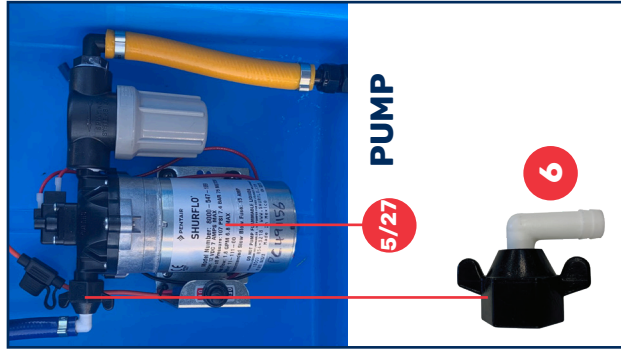
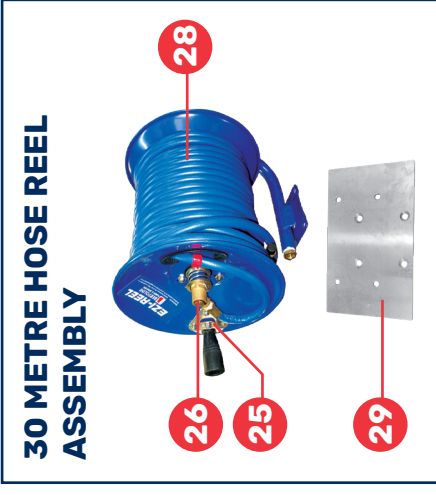

BAM200 12 VOLT SPRAYER PARTS LIST

No.	Part No.	Description	QTY
1	200TANK	Tank & Tank Fittings	1
2	3542010	200 litre deckmount tank	1
3	TN5088PP	Lid BAM tank female	1
	20102020	Nipple 1/2" x 1/2" PP Drain	1
	CP19438-EPR	Drain Cap	1
4	2787-1	Drain Cap Gasket	1
		Drain Plug	1
5	8000-547-189	Pump & Filter Assembly	1
6	8-034-01	Shurflo 6.8lpm, 107psi 12 volt pump	1
7	1366	Shurflo elbow hose tail 1/2"	1
8	1353	Otiker clip 1300 hose	3
8a	1353	Ag spray hose 13mm 600psi	0.2mtr
9	AAB122-1/2-PP	Hose ag spray 13mm 600 psi (inside tank)	0.5mtr
9a	CP45102-3-SSPP	Complete 1/2" line filter with 50 mesh	1
9b	CP23173-EPR	50 mesh screen replacement part	1
10	TE2088PP	Filter bowl gasket	1
33	8121-NYB-540TD	Male threaded elbow hose tail	1
32	G40001	1/2" elbow tail and backnut	1
31	8400-500-NYB	Gasket 3/8" 25x16x3 white nitr	1
30	CP8027-NYB	Hose shank connector	1
		Tee-Jet cap nylon	1
11	1559	Electrical Assembly	1
11a	1560	Fuse holder	1
12	BAML00M	Fuse (mini 10AMP)	1
13	1561	Wiring loom	1
14	1562	Cover (switch w/proof)	1
15	1866	Switch	1
18	BAMSWITCHASSY	Switch Bracket	1
		Full electrical assembly kit (includes all the above)	1

No.	Part No.	Description	QTY
		Sundry Components	
	1077	Pump mount screws 3/16X1 ZP	4
	1122	Pump mount washers M6	4
	1565	Bullet terminal male - BAMs	2
	1566	Bullet terminal female - BAMs	2
	1569	Eye terminal 8M	2
	1564	Spade terminal	2
19	P95492	Hose Reel & Gun	1
20	SJ202	Hose reel bracket	1
25	3063-1	15mtr EZI-Reel	1
26	3063	Hose reel handle	1
23	35.901.16	Hose reel swivel	1
24	26.1502.45	Spot 300 spray gun	1
22	P95493	Swivel for spray gun	1
		Spray gun holster	1
27	2088-343-135	Optional Upgrades	1
28	SJ201	Shurflo 11.3lpm, 45psi 12 volt pump	1
29	P97003-01	30mtr EZI-Reel	1
		30mtr hose reel bracket	1

CORRECT AS OF JULY 2019. ALL PARTS LISTS ARE ALSO AVAILABLE ON OUR WEBSITE

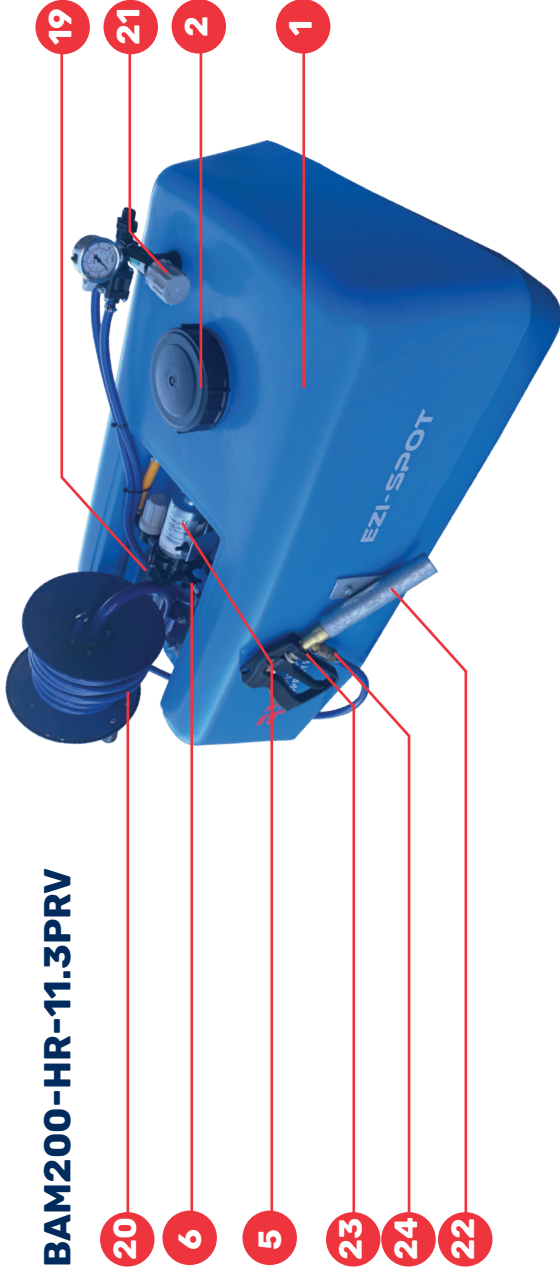

CORRECT AS OF JULY 2019. ALL PARTS LISTS ARE ALSO AVAILABLE ON OUR WEBSITE

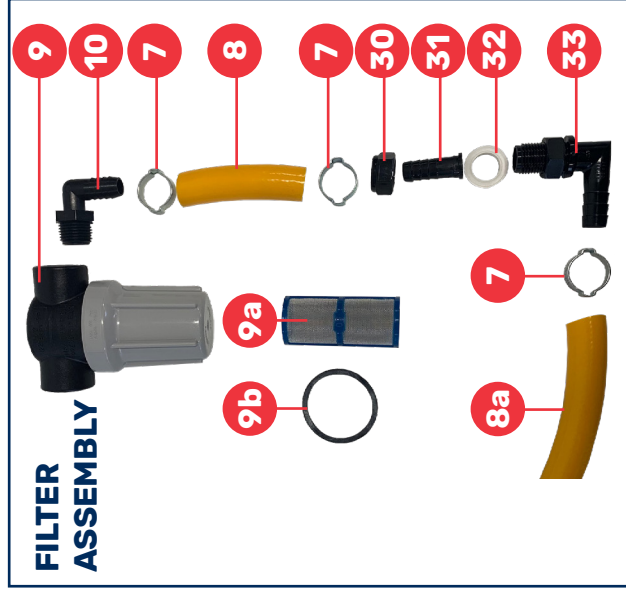
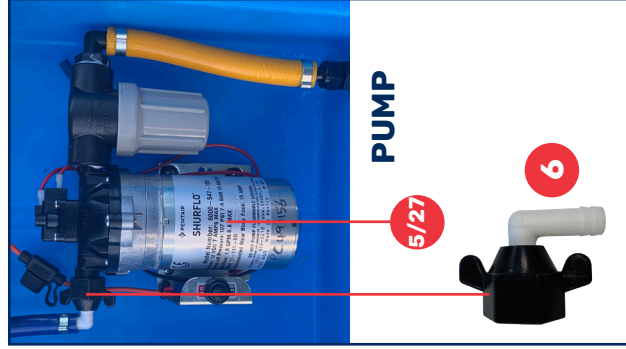
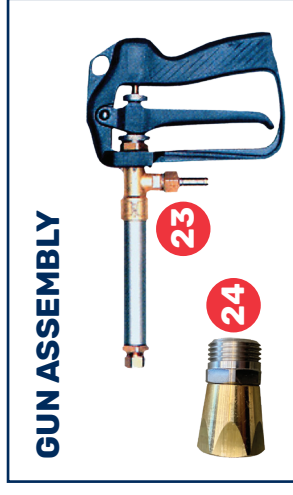
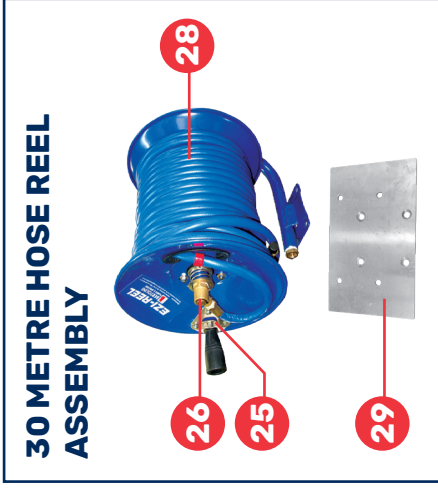

BAM200 12 VOLT SPRAYER PARTS LIST

No.	Part No.	Description	QTY
1	200TANK	Tank & Tank Fittings	1
2	3542010	200 litre deckmount tank	1
3	TN5088PP	Lid BAM tank female	1
	20102020	Nipple 1/2" x 1/2" PP Drain	1
	CP19438-EPR	Drain Cap	1
4	2787-1	Drain Cap Gasket	1
		Drain Plug	1
5	8000-547-189	Pump & Filter Assembly	1
6	8-034-01	Shurflo 6.8lpm, 107psi 12 volt pump	1
7	1366	Shurflo elbow hose tail 1/2"	1
8	1353	Otiker clip 1300 hose	3
8a	1353	Ag spray hose 13mm 600psi	0.2mtr
9	AAB122-1/2-PP	Hose ag spray 13mm 600 psi (inside tank)	0.5mtr
9a	CP45102-3-SSPP	Complete 1/2" line filter with 50 mesh	1
9b	CP23173-EPR	50 mesh screen replacement part	1
10	TE2088PP	Filter bowl gasket	1
33	8121-NYB-540TD	Male threaded elbow hose tail	1
32	G40001	1/2" elbow tail and backnut	1
31	8400-500-NYB	Gasket 3/8" 25x16x3 white nitr	1
30	CP8027-NYB	Hose shank connector	1
		Tee-Jet cap nylon	1
11	1559	Electrical Assembly	1
11a	1560	Fuse holder	1
12	BAML00M	Fuse (mini 10AMP)	1
13	1561	Wiring loom	1
14	1562	Cover (switch w/proof)	1
15	1866	Switch	1
18	BAMSWITCHASSY	Switch Bracket	1
		Full electrical assembly kit (includes all the above)	1

No.	Part No.	Description	QTY
		Sundry Components	
	1077	Pump mount screws 3/16X1 ZP	4
	1122	Pump mount washers M6	4
	1565	Bullet terminal male - BAMs	2
	1566	Bullet terminal female - BAMs	2
	1569	Eye terminal 8M	2
	1564	Spade terminal	2
		Hose Reel & Gun	
19	P95492	Hose reel bracket	1
20	SJ202	15mtr EZI-Reel	1
25	3063-1	Hose reel handle	1
26	3063	Hose reel swivel	1
23	35.901.16	Spot 300 spray gun	1
24	26.1502.45	Swivel for spray gun	1
22	P95493	Spray gun holster	1
21	BA12VREG	Pressure Regulator	1
		Pressure regulator	
27	2088-343-135	Optional Upgrades	1
28	SJ201	Shurflo 11.3lpm, 45psi 12 volt pump	1
29	P97003-01	30mtr EZI-Reel	1
		30mtr hose reel bracket	1

CORRECT AS OF JULY 2019. ALL PARTS LISTS ARE ALSO AVAILABLE ON OUR WEBSITE

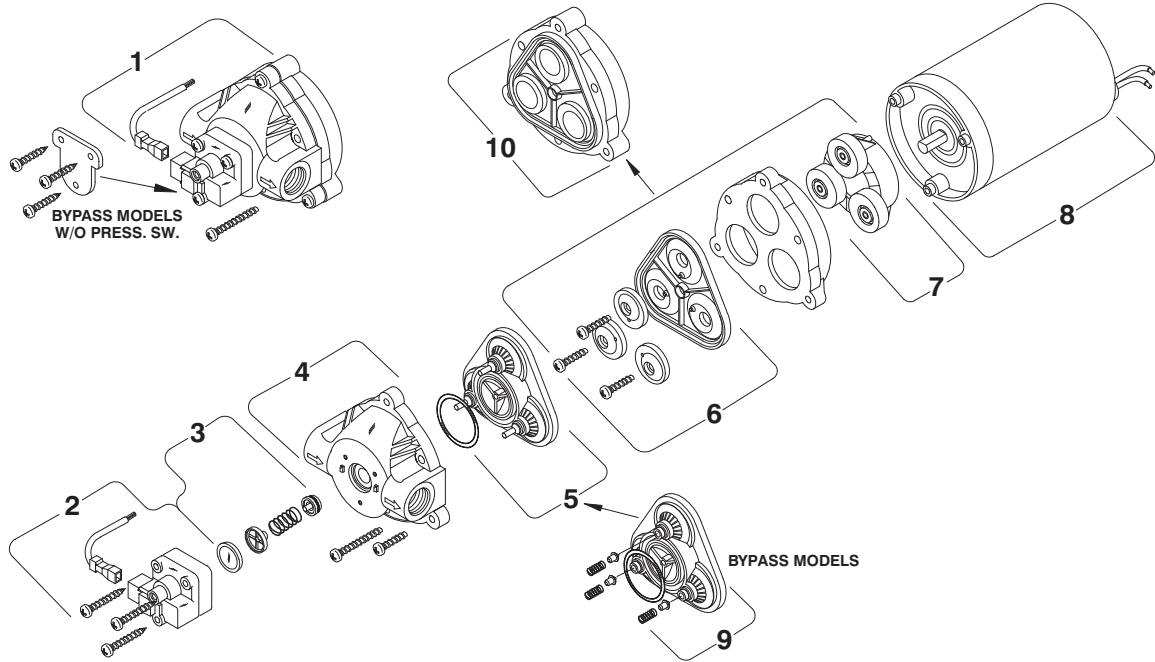

DESCRIPTION
PART No.

1) Complete Pump Head	N/A
2) Switch Assembly	94-229-08
3) Check Valve Assembly	94-374-08
4) Upper Housing	94-378-00
5) Valve Assembly (Standard)	N/A
6) Diaphragm	N/A
7) Drive Assembly	N/A
8) Motor	94-11-111-00
9) Valve Assembly (Bypass)	94-391-46
10) Solid Diaphragm/Drive Assembly	94-385-32

SHURflo

KITS FOR MODEL 2088-343-135

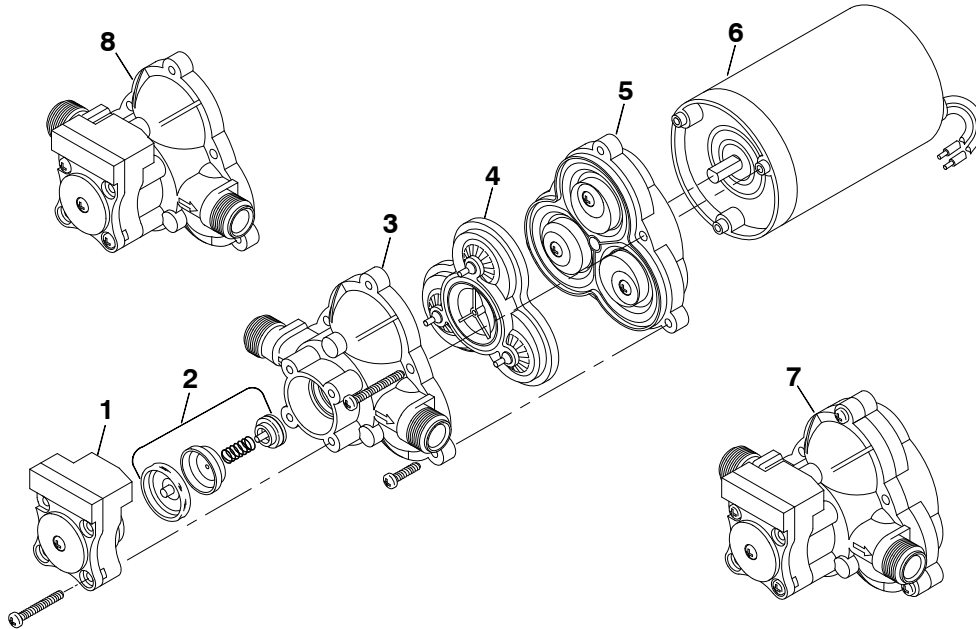
Issued: 7-11-06 REVISED



1) Switch Assembly	94-230-36
2) Check Valve Assembly	94-237-05
3) Upper Housing	94-231-30
4) Valve Assembly	94-232-05
5) Diaphragm/Lower Housing	94-238-03
6) Motor	11-111-00
7) Complete Pump Head	N/A
8) Upper Housing/Switch Assy	N/A

ALL PARTS LISTS ARE ALSO AVAILABLE ON OUR WEBSITE

Thank you for choosing a BA Pumps & Sprayers Product!

BA Pumps & Sprayers is a New Zealand family owned and operated business. We are proud to be members of Buy NZ Made and strive to offer as many New Zealand made products as possible.

We specialise in supplying the latest spraying and pressure cleaning technology along with a comprehensive range of parts and accessories to our clients. This is achieved from our close business relationship with many overseas suppliers such as Idromeccanica Bertolini for the latest pump technology and TeeJet® for the best in spray application technology.

All our products are supported by a comprehensive dealer network throughout New Zealand. We would like to thank you for choosing BA Pumps & Sprayers products and trust that our product and service will surpass your expectations.

You might also like our DM range of deckmount spray units designed to fit side-by-sides and mules!

